

APPENDIX C

CERTIFICATE OF TITLE AND DEPOSITED PLAN FOR LOT 6 DP709704



NEW SOUTH WALES LAND REGISTRY SERVICES - TITLE SEARCH
-----FOLIO: 6/709704

SEARCH DATE	TIME	EDITION NO	DATE
-----	----	-----	----
17/4/2025	9:33 AM	12	15/11/2024

LAND
-----LOT 6 IN DEPOSITED PLAN 709704
AT YASS
LOCAL GOVERNMENT AREA YASS VALLEY
PARISH OF HUME COUNTY OF MURRAY
TITLE DIAGRAM DP709704FIRST SCHEDULE

LEONIE GAE AMOS (T AU588821)

SECOND SCHEDULE (4 NOTIFICATIONS)

- 1 RESERVATIONS AND CONDITIONS IN THE CROWN GRANT(S)
- 2 DP709704 EASEMENT TO DRAIN SEWAGE 2 WIDE AFFECTING THE PART
OF THE LAND ABOVE DESCRIBED SHOWN SO BURDENED IN THE
TITLE DIAGRAM
- 3 DP709704 RESTRICTION(S) ON THE USE OF LAND
- 4 AU588822 MORTGAGE TO MACQUARIE BANK LIMITED

NOTATIONS

UNREGISTERED DEALINGS: NIL

*** END OF SEARCH ***

5692

PRINTED ON 17/4/2025

Search Date/Time: 17/04/2025 9:33AM

LEGALSTREAM AUSTRALIA - hereby certifies that the information contained in this document has been provided
electronically by the Registrar General in accordance with section 96B(2) of the Real Property Act 1900.

* Any entries preceded by an asterisk do not appear on the current edition of the Certificate of Title. Warning: the information
appearing under notations has not been formally recorded in the Register.

SIGNATURES AND SEALS ONLY

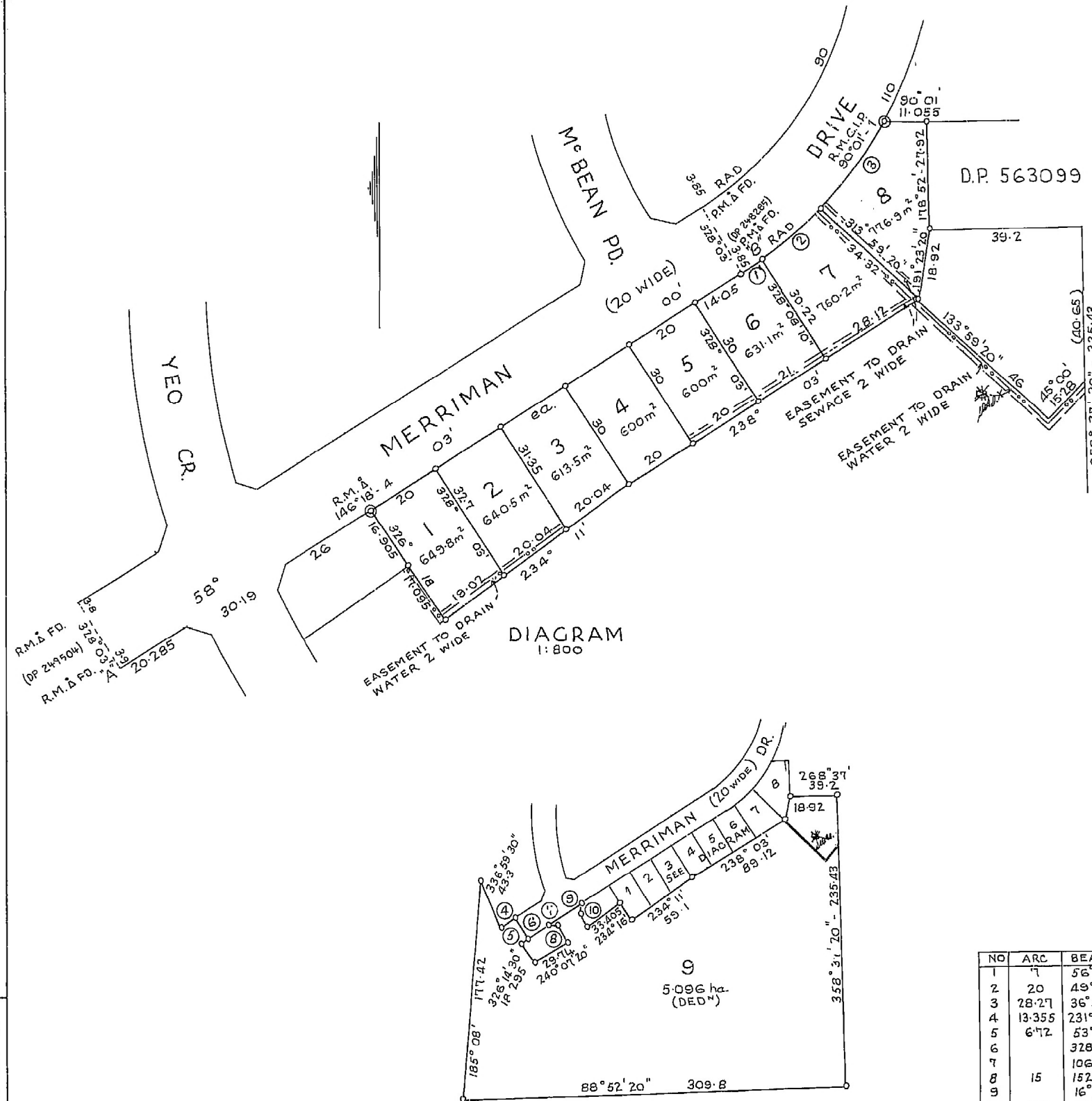

Council Clerk's Certificate.
I hereby certify that:
(a) the requirements of the Local Government Act, 1919 (other than the requirements for the registration of plans), and
(b) the requirements of section 34B of the Metropolitan Water, Sewerage and Drainage Act, 1924, as amended, (Hunter-District Water, Sewerage and Drainage Act, 1939, as amended),
have been complied with by the applicant in relation to the proposed
SUBDIVISION
(Insert "new road", "subdivision" or "consolidated lot" set out herein.)
Subdivision No. 25/1984
Date 27th June, 1984
(Signature) [Signature]
Council Clerk.
*This part of certificate to be deleted where the application is only for a consolidated lot or the opening of a new road or where the land to be subdivided is wholly outside the areas of operations of the Metropolitan Water Sewerage and Drainage Board and the Hunter District Water Board.
Delete if inapplicable.

NO	ARC	BEARING	DIST.	RAD.
1	7	56°13'40"	7	110
2	20	49°11'50"	19.97	110
3	28.27	36°37'40"	28.195	110
4	13.355	231°41'	13.325	60
5	6.72	53°14'	6.71	40
6		328°03'	20	
7		106°28'	6.635	
8	15	152°10'	14.995	210
9		16°50'	7.525	
10	14.2	332°44'	14.195	190

D.P. 709704

Registered: 10-12-1984
C.A. No 25/1984 of 27.6.1984
Title System: TORRENS
Purpose: SUBDIVISION
Ref. Map: YASS Sh. 50
Last Plan: D.P. 249504#

PLAN
OF SUBDIVISION OF LOT
116 D.P. 249504

Reduction Ratio 1: 2500
Lengths are in metres.

Mun./Shire: YASS
City: YASS
Locality: YASS
Parish: HUME
County: MURRAY

This is sheet 1 of my plan in sheets.
(Delete if inapplicable.)

WILLIAM ANTHONY SMITH
of P.O. BOX 50, YASS,
a surveyor registered under the Surveyors Act, 1929, as amended, hereby certify that the survey represented in this plan is accurate and has been made (1) by me (2) under my immediate supervision in accordance with the Survey Practice Regulations, 1931 and was completed on 16th JULY 1984.
Signature: [Signature]
Surveyor registered under Surveyors Act, 1929, as amended.
Datum Line of Azimuth: A - B
*Strike out either (1) or (2). Insert date of survey.

Panel for use only for statements of intention to dedicate public roads or to create public reserves, drainage reserves, easements or restrictions as to user.

PURSUANT TO SECTION 88(b) OF THE CONVEYANCING ACT 1919-1964 AS AMENDED IT IS INTENDED TO CREATE:
1) EASEMENTS TO DRAIN WATER 2 WIDE SHOWN
2) EASEMENTS TO DRAIN SEWAGE 2 WIDE SHOWN
3) RESTRICTIONS AS TO USER
4) EASEMENT TO PUMP DRAIN WATER 2 WIDE SHOWN

SURVEYOR'S REFERENCE: 8421

WARNING: CREASING OR FOLDING WILL LEAD TO REJECTION

I, Bruce Richard Davies, Under Secretary for Lands and Registrar General for New South Wales, certify that this negative is a photograph made as a permanent record of a document in my custody this day.
[Signature]
11th December, 1984.